



Regent Court, Briggate, Leeds
£775 pcm

1 bedroom apartment to rent



This one bedroom ground floor apartment has the benefit of communal gardens and has secure entrances in the centre of Leeds.

Deposit: £700

Holding Deposit: £100



Whilst every effort is made to ensure the accuracy of these details, it should be noted that the measurements are approximate only. Floorplans are for representation purposes only and prepared according to the RICS Code of Measuring Practice by our floorplan provider. Therefore, the layout of doors, windows and rooms are approximate and should be regarded as such by any prospective tenant.

GROUND FLOOR
355 sq.ft. (33.0 sq.m.) approx.

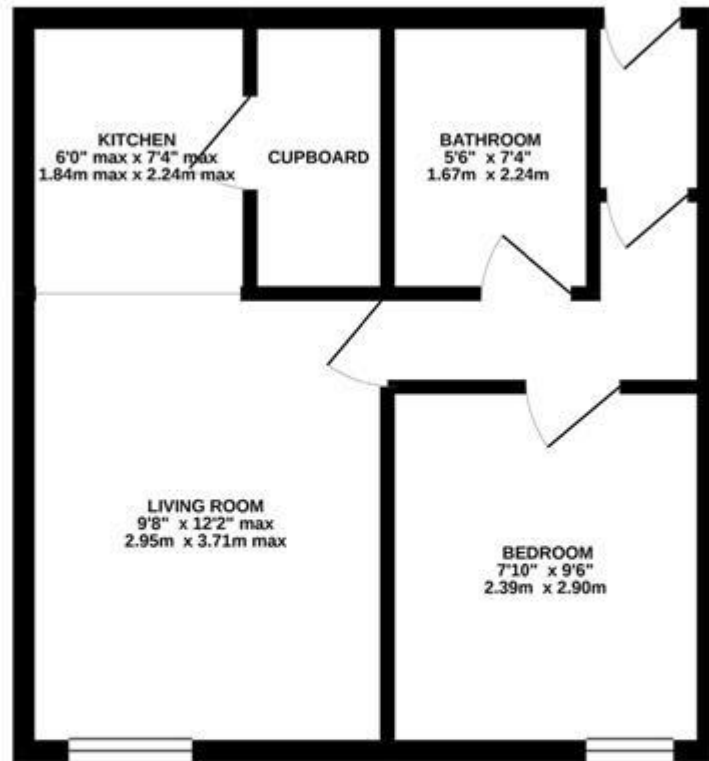

TOTAL FLOOR AREA: 355 sq.ft. (33.0 sq.m.) approx.

Whilst every attempt has been made to ensure the accuracy of the floorplan contained here, measurements of doors, windows, rooms and any other items are approximate and no responsibility is taken for any error, omission or mis-statement. This plan is for illustrative purposes only and should be used as such by any prospective purchaser. The services, systems and appliances shown have not been tested and no guarantee as to their operability or efficiency can be given.
Made with MapInfo ©2021

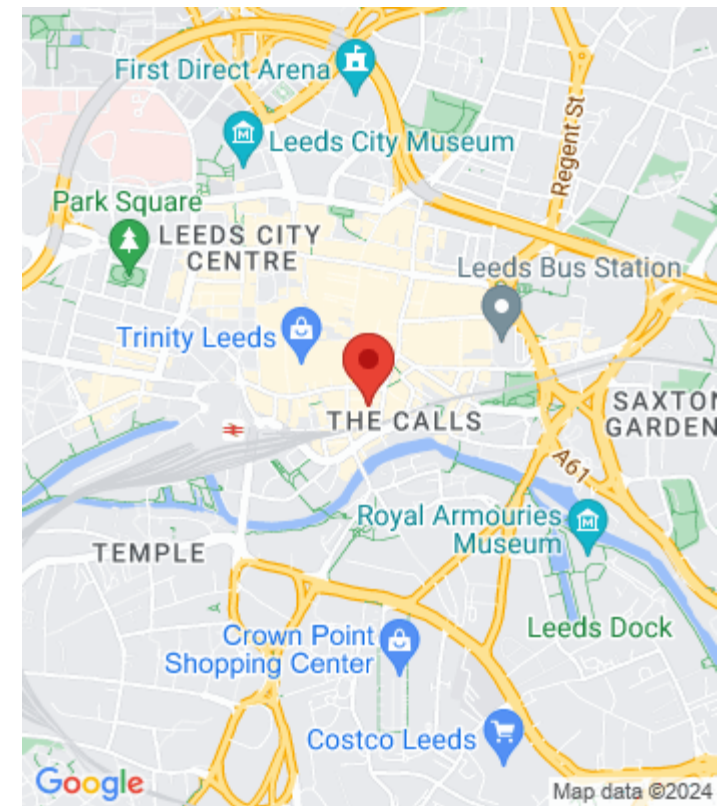

Viewing by appointment only
Real Estate Sales & Lettings
15 Queen Square, Leeds, West Yorkshire LS2 8AJ
Tel: 0113 266 1020 Email: rent@resaluk.com Website: www.resaluk.com